

---

## Licensing Sub-Committee B

---

TUESDAY, 3RD OCTOBER, 2006 at 18:00 HRS - CIVIC CENTRE, HIGH ROAD, WOOD GREEN, N22 8LE.

MEMBERS: Councillors Mughal, Peacock and Dobbie

### **AGENDA**

**1. APOLOGIES**

**2. URGENT BUSINESS**

The Chair will consider the admission of any late items of urgent business. (Late items will be considered under the agenda item where they appear. New items will be dealt with at Item 7 below).

**3. DECLARATIONS OF INTEREST**

A member with a personal interest in a matter who attends a meeting of the Authority at which the matter is considered must disclose to that meeting the existence and nature of that interest at the commencement of that consideration, or when the interest becomes apparent.

A members with a personal interest in a matter also has a prejudicial interest in that matter if the interest is one which a member of the public with knowledge of the relevant facts would reasonably regard as so significant that it is likely to prejudice the member's judgement of the public interest.

**4. SUMMARY OF PROCEDURE (PAGES 1 - 4)**

The Chair will explain the procedure that the Committee will follow for each of the hearings considered. A copy of the procedure is attached

**5. APPLICATION FOR A PREMISES LICENCE - SALONICA CAFE, 1 GRAND PARADE, GREEN LANES, LONDON N4 1JX (PAGES 5 - 42)**

To consider an application to provide licensable activity in the form of the sale of alcohol, late night refreshment and regulated entertainment.

Yuniea Semambo  
Head of Member Services  
5<sup>th</sup> Floor  
River Park House  
225 High Road  
Wood Green  
London N22 8HQ

Nicolas Mattis  
Principal Support Officer (Council)  
Tel: 020-8489 2916  
Fax: 020-8489 2660  
Email: [nicolas.mattis@haringey.gov.uk](mailto:nicolas.mattis@haringey.gov.uk)

## Agenda Item 4

<p><b><u>LICENSING SUB-COMMITTEE HEARINGS</u></b>  <b><u>PROCEDURE SUMMARY</u></b></p>	<p>Tick box to record action / decision</p>
<p><u>INTRODUCTION</u></p>	
<p>1. The Chair introduces himself and invites other Members, Council officers, Police, Applicant and Objectors to do the same.</p>	
<p>2. The Chair invites Members to disclose any prior contacts (before the hearing) with the parties or representations received by them</p>	
<p>3. The Chair explains the procedure to be followed by reference to this summary which will be distributed.</p>	
<p><u>NON-ATTENDANCE BY PARTY OR PARTIES</u></p>	
<p>4. If one or both of the parties fails to attend, the Chair decides whether to:</p>	
<p>(i) grant an adjournment to another date, or</p>	
<p>(ii) proceed in the absence of the non-attending party.</p> <p>Normally, an absent party will be given one further chance to attend.</p>	
<p><u>TOPIC HEADINGS</u></p>	
<p>5. The Chair suggests the "topic headings" for the hearing.</p> <p>In the case of the majority of applications for variation of hours, or other terms and conditions, the main topic is:</p> <p><b>Whether the extensions of hours etc. applied for would conflict with the four licensing objectives i.e.</b></p>	
<p>(i) the prevention of crime and disorder,</p>	
<p>(ii) public safety,</p>	

(iii) the prevention of public nuisance, and	
(iv) the protection of children from harm.	
6. The Chair invites comments from the parties on the suggested topic headings and decides whether to confirm or vary them.	
<u>WITNESSES</u>	
7. The Chair asks whether there are any requests by a party to call a witness and decides any such request.	
8. <u>Only</u> if a witness is to be called, the Chair then asks if there is a request by an opposing party to “cross-examine” the witness. The Chair then decides any such request.	
<u>DOCUMENTARY EVIDENCE</u>	
9. The Chair asks whether there are any requests by any party to introduce late documentary evidence.	
10. If so, the Chair will ask the other party if they object to the admission of the late documents.	
11. If the other party <u>do object</u> to late admission, the following criteria shall be taken into account when the Chair decides whether or not to admit the late documents:	
(i) What is the reason for the documents being late?	
(ii) Will the other party be unfairly taken by surprise by the late documents?	
(iii) Will the party seeking to admit late documents be put at a major disadvantage if admission of the documents is refused?	
(iv) Is the late evidence really important?	
(v) Would it be better and fairer to adjourn to a later date?	
<u>THE LICENSING OFFICER'S INTRODUCTION</u>	
12. The Licensing Officer introduces the report explaining, for example, the existing hours, the hours applied for and	

<p>the comments of the other Council Services or outside official bodies. This should be as “neutral” as possible between the parties.</p>	
<p>13. The Licensing Officer can be questioned by Members and then by the parties.</p>	
<p><u>THE HEARING</u></p>	
<p>14. This takes the form of a discussion led by the Chair. The Chair can vary the order as appropriate but it should include:</p>	
<p>(i) an introduction by the Objectors' main representative</p>	
<p>(ii) an introduction by the Applicant or representative</p>	
<p>(iii) questions put by Members to the Objectors</p>	
<p>(iv) questions put by Members to the Applicant</p>	
<p>(v) questions put by the Objectors to the Applicant</p>	
<p>(vi) questions put by the Applicant to the Objectors</p>	
<p><u>CLOSING ADRESSES</u></p>	
<p>15. The Chair asks each party how much time is needed for their closing address, if they need to make one.</p>	
<p>16. Generally, the Objectors make their closing address before the Applicant who has the right to the final closing address.</p>	
<p><u>THE DECISION</u></p>	
<p>17. Members retire with the Committee Clerk and legal representative</p>	

<p>to consider their decision including the imposition of conditions.</p> <p>The decision is put in writing and Members return to the meeting.</p>	
<p>18. The Chair should read out the following statement before asking the Committee Clerk to read out in public a summary of the Committee's Decision:</p> <p><i>“The Committee Clerk will read out a summary of the Committee’s Decision. The Parties will receive a written Decision Notice in which the Decision will be formally set out. Please note that the written Decision will be substantially the same although the wording might vary slightly from the summary read out.”</i></p>	

**Licensing Act 2003 Sub-Committee 3<sup>rd</sup> OCTOBER 2006**

Report title: Application for a Premises Licence SALONICA CAFÉ, 1 GRAND PARADE, GREEN LANES, LONDON, N4 1JX

Report of: The Lead Officer Licensing

Ward(s) affected

**1. Purpose**

To consider an application by ANDREAS STRAVOGIANNIS AND HRIZANTEMA MLADENOVA, SALONICA CAFE to provide a licensable activity in the form of the sale of Alcohol, Late Night Refreshment and Regulated Entertainment

**2. Recommendations**

- 2.1 (a) Grant the application as asked  
 (b) Modify the conditions of the licence, by altering or omitting or adding to them  
 (c) Reject the whole or part of the application

The Committee is asked to note that it may not modify the conditions or reject the whole or part of the application unless it is necessary to promote the licensing objectives.

Report authorised by: Robin Payne.....  
 Assistant Director Enforcement Services

Contact Officer: Ms Daliah Barrett

Telephone: 020 8489 5103

**3. Executive summary**

For consideration by Sub Committee under Licensing Act 2003 for a Premises Licence.

**4. Access to information:**

Local Government (Access to Information) Act 1985  
 Background Papers

The following Background Papers are used in the preparation of this Report:  
**File: SALONICA CAFE**

The Background Papers are located at Enforcement Service, Civic Centre, High Road Wood Green N22

## 5. REPORT

### Background

5.1 Application by **ANDREAS STRAVOGIANNIS AND HRIZANTEMA MLADENOVA** for a Premises Licence in respect of **SALONICA CAFÉ, 1 GRAND PARADE, GREEN LANES, LONDON, N4 1JX** under the Licensing Act 2003.

### 5.2 Details for a new Premises Licence - APP 1

#### Opening Hours for Public

Sunday to Saturday 08.00 - 05.00

#### Late Night Refreshment

Sunday to Saturday 23.00 – 05.00

### 5.3 Crime and Disorder

A buzzer entry system will be used between 23.00 and 05.00

### 5.4 Public Safety

Fire safety equipment will be checked regularly and any requirements made by the Fire Safety Officer will be complied with.

### 5.5 Public Nuisance

There will no take away food or drink.

Signs will be displayed at the exit reminding customers to leave quietly and respect the neighbours.

### 5.6 Child Protection

No one under 18 will be permitted entry to the premises after 23.00.

## 6. RELEVANT REPRESENTATIONS (CONSULTATION)

### Responsible Authorities:

### 6.1 Comments of Metropolitan Police

The Police have no adverse comments to make regarding this application.



**6.2 Comments of Enforcement Services:**

**Noise Team**

Have made comments to this application. **App 2**

**Food Team**

Have no objections to this application

**Health and Safety**

Have no objections to this application

**Trading Standards**

Have no objections to this application

**6.3 Fire Officer**

The Fire Officer has no objections to this application

**6.5 Planning Officer**

Has no objection to this application.

**6.6. Comments of Child Protection Agency or Nominee**

Have no objections to this application.

**7.0 Interested Parties**

Objections have been received against this application. **App 3**

**8.0 Financial Comments**

The fee which would be applicable for this application is **£190.00**

**APP 1**

18.6m

BM 18.51m

GREEN LANES

The Salisbury (PH)

1

EI Sub

Ward Bdy

CR

© Crown Copyright LB Haringey LA086401 2006

Enforcement Service  
Civic Centre  
High Road  
Wood Green  
London  
N22 8LE

**HARINGEY COUNCIL**

Environmental Control



Scale: 1:278

FOO103055703

CHQ 190

Application for a premises licence to be granted  
under the Licensing Act 2003

## PLEASE READ THE FOLLOWING INSTRUCTIONS FIRST

Before completing this form please read the guidance notes at the end of the form.  
If you are completing this form by hand please write legibly in block capitals. In all cases ensure that your answers are inside the boxes and written in black ink. Use additional sheets if necessary.

You may wish to keep a copy of the completed form for your records.

I/We ANDREAS STRAVOGIANNIS & HRIZANTEMA MLADENOVA

(Insert name(s) of applicant)

apply for a premises licence under section 17 of the Licensing Act 2003 for the premises described in Part 1 below (the premises) and I/we are making this application to you as the relevant licensing authority in accordance with section 12 of the Licensing Act 2003

## Part 1 – Premises Details

Postal address of premises or, if none, Ordnance Survey map reference or description SALONICA CAFÉ 1 GRAND PARADE GREEN LANES			
Post town	LONDON	Post code	N4 1JX

Telephone number at premises (if any)	0208 372 0605
Non-domestic rateable value of premises	£7800

## Part 2 - Applicant Details

Please state whether you are applying for a premises licence as  
Please tick yes

- a) an individual or individuals \*  please complete section (A)
- b) a person other than an individual \*
- i. as a limited company  please complete section (B)
- ii. as a partnership  please complete section (B)
- iii. as an unincorporated association or  please complete section (B)
- iv. other (for example a statutory corporation)  please complete section (B)
- c) a recognised club  please complete section (B)
- d) a charity  please complete section (B)

- e) the proprietor of an educational establishment  please complete section (B)
- f) a health service body  please complete section (B)
- g) a person who is registered under Part 2 of the Care Standards Act 2000 (c14) in respect of an independent hospital  please complete section (B)
- h) the chief officer of police of a police force in England and Wales  please complete section (B)

\* If you are applying as a person described in (a) or (b) please confirm:

Please tick yes

- I am carrying on or proposing to carry on a business which involves the use of the premises for licensable activities; or
- I am making the application pursuant to a
  - statutory function or
  - a function discharged by virtue of Her Majesty's prerogative

**(A) INDIVIDUAL APPLICANTS** (fill in as applicable)

Mr <input checked="" type="checkbox"/>	Mrs <input type="checkbox"/>	Miss <input type="checkbox"/>	Ms <input type="checkbox"/>	Other Title (for example, Rev)	
Surname STRAVOGIANNIS			First names ANDREAS		
I am 18 years old or over				<input checked="" type="checkbox"/> Please tick yes	
Current postal address if different from premises address		159 GOSPATRICK ROAD TOTTENHAM			
Post Town	LONDON		Postcode	N17 1JG	
Daytime contact telephone number			07890 527453		
E-mail address (optional)					

**SECOND INDIVIDUAL APPLICANT** (if applicable)

Mr <input type="checkbox"/>	Mrs <input checked="" type="checkbox"/>	Miss <input type="checkbox"/>	Ms <input type="checkbox"/>	Other Title (for example, Rev)	
Surname MLADENOVA			First names HRIZANTEMA		
I am 18 years old or over				<input checked="" type="checkbox"/> Please tick yes	

Current postal address if different from premises address		159 GOSPATRICK ROAD TOTTENHAM	
Post Town	LONDON	Postcode	N17 1JG
Daytime contact telephone number		07890 233364	
E-mail address (optional)			

**(B) OTHER APPLICANTS**

Please provide name and registered address of applicant in full. Where appropriate please give any registered number. In the case of a partnership or other joint venture (other than a body corporate), please give the name and address of each party concerned.

Name
Address
Registered number (where applicable)
Description of applicant (for example, partnership, company, unincorporated association etc.)
Telephone number (if any)
E-mail address (optional)

**Part 3 Operating Schedule**

When do you want the premises licence to start?

Day	Month	Year
2	2	092006

If you wish the licence to be valid only for a limited period, when do you want it to end?

Day	Month	Year

Please give a general description of the premises (please read guidance note1)

CAFÉ  
 TEAS / COFFEES / SANDWICHES  
 NO HOT FOOD  
 AMUSEMENT ONLY MACHINES

If 5,000 or more people are expected to attend the premises at any one time, please state the number expected to attend.

What licensable activities do you intend to carry on from the premises?

(Please see sections 1 and 14 of the Licensing Act 2003 and Schedules 1 and 2 to the Licensing Act 2003)

**Provision of regulated entertainment**

Please tick yes

- a) plays (if ticking yes, fill in box A)
- b) films (if ticking yes, fill in box B)
- c) indoor sporting events (if ticking yes, fill in box C)
- d) boxing or wrestling entertainment (if ticking yes, fill in box D)
- e) live music (if ticking yes, fill in box E)
- f) recorded music (if ticking yes, fill in box F)
- g) performances of dance (if ticking yes, fill in box G)
- h) anything of a similar description to that falling within (e), (f) or (g) (if ticking yes, fill in box H)

**Provision of entertainment facilities:**

- i) making music (if ticking yes, fill in box I)
- j) dancing (if ticking yes, fill in box J)
- k) entertainment of a similar description to that falling within (i) or (j) (if ticking yes, fill in box K)

**Provision of late night refreshment** (if ticking yes, fill in box L)

**Supply of alcohol** (if ticking yes, fill in box M)

In all cases complete boxes N, O and P

**A**

Plays Standard days and timings (please read guidance note 6)			Will the performance of a play take place indoors or outdoors or both – please tick (please read guidance note 2)	Indoors	<input type="checkbox"/>
Day	Start	Finish		Outdoors	<input type="checkbox"/>
Mon			<b>Please give further details here</b> (please read guidance note 3)	Both	<input type="checkbox"/>
Tue					
Wed			<b>State any seasonal variations for performing plays</b> (please read guidance note 4)		
Thur					
Fri			<b>Non standard timings. Where you intend to use the premises for the performance of plays at different times to those listed in the column on the left, please list</b> (please read guidance note 5)		
Sat					
Sun					



**B**

<b>Films</b> Standard days and timings (please read guidance note 6)			<b><u>Will the exhibition of films take place indoors or outdoors or both – please tick</u></b> (please read guidance note 2)	Indoors	<input type="checkbox"/>
				Outdoors	<input type="checkbox"/>
				Both	<input type="checkbox"/>
<b>Day</b>	<b>Start</b>	<b>Finish</b>	<b><u>Please give further details here</u></b> (please read guidance note 3)		
Mon					
Tue					
Wed			<b><u>State any seasonal variations for the exhibition of films</u></b> (please read guidance note 4)		
Thur					
Fri					
Sat			<b><u>Non standard timings. Where you intend to use the premises for the exhibition of films at different times to those listed in the column on the left, please list</u></b> (please read guidance note 5)		
Sun					

**C**

Indoor sporting events Standard days and timings (please read guidance note 6)			<u>Please give further details</u> (please read guidance note 3)
Day	Start	Finish	
Mon			
Tue			<b><u>State any seasonal variations for indoor sporting events</u></b> (please read guidance note 4)
Wed			
Thur			<b><u>Non standard timings. Where you intend to use the premises for indoor sporting events at different times to those listed in the column on the left, please list</u></b> (please read guidance note 5)
Fri			
Sat			
Sun			

**D**

<b>Boxing or wrestling entertainments</b> Standard days and timings (please read guidance note 6)			<b>Will the boxing or wrestling entertainment take place indoors or outdoors or both – please tick</b> (please read guidance note 2)	Indoors	<input type="checkbox"/>
				Outdoors	<input type="checkbox"/>
				Both	<input type="checkbox"/>
Day	Start	Finish			
Mon			<b>Please give further details here</b> (please read guidance note 3)		
Tue			<b>State any seasonal variations for boxing or wrestling entertainment</b> (please read guidance note 4)		
Wed			<b>Non standard timings. Where you intend to use the premises for boxing or wrestling entertainment at different times to those listed in the column on the left, please list</b> (please read guidance note 5)		
Thur					
Fri					
Sat					
Sun					

**E**

<b>Live music</b> Standard days and timings (please read guidance note 6)			<b>Will the performance of live music take place indoors or outdoors or both – please tick</b> (please read guidance note 2)		Indoors <input type="checkbox"/>	
					Outdoors <input type="checkbox"/>	
					Both <input type="checkbox"/>	
Day	Start	Finish	<b>Please give further details here</b> (please read guidance note 3)			
Mon						
			<b>State any seasonal variations for the performance of live music</b> (please read guidance note 4)			
Tue						
			<b>Non standard timings. Where you intend to use the premises for the performance of live music at different times to those listed in the column on the left, please list</b> (please read guidance note 5)			
Wed						
Thur						
Fri						
Sat						
Sun						

**F**

Recorded music Standard days and timings (please read guidance note 6)			<u>Will the playing of recorded music take place indoors or outdoors or both – please tick</u> (please read guidance note 2)	Indoors	<input type="checkbox"/>
				Outdoors	<input type="checkbox"/>
				Both	<input type="checkbox"/>
Day	Start	Finish			
Mon			<u>Please give further details here</u> (please read guidance note 3)		
Tue					
Wed			<u>State any seasonal variations for the playing of recorded music</u> (please read guidance note 4)		
Thur					
Fri			<u>Non standard timings. Where you intend to use the premises for the playing of recorded music at different times to those listed in the column on the left, please list</u> (please read guidance note 5)		
Sat					
Sun					

G

Performances of dance Standard days and timings (please read guidance note 6)			<u>Will the performance of dance take place indoors or outdoors or both – please tick</u> (please read guidance note 2)	Indoors	<input type="checkbox"/>
Day	Start	Finish		Outdoors	<input type="checkbox"/>
Mon			<b><u>Please give further details here</u></b> (please read guidance note 3)	Both	<input type="checkbox"/>
Tue					
Wed			<b><u>State any seasonal variations for the performance of dance</u></b> (please read guidance note 4)		
Thur					
Fri			<b><u>Non standard timings. Where you intend to use the premises for the performance of dance at different times to those listed in the column on the left, please list</u></b> (please read guidance note 5)		
Sat					
Sun					

**H**

<p><b>Anything of a similar description to that falling within (e), (f) or (g)</b> Standard days and timings (please read guidance note 6)</p>			<p><b><u>Please give a description of the type of entertainment you will be providing</u></b></p>		
<b>Day</b>	<b>Start</b>	<b>Finish</b>	<p><b><u>Will this entertainment take place indoors or outdoors or both – please tick</u></b> (please read guidance note 2)</p>	Indoors	<input type="checkbox"/>
Mon				Outdoors	<input type="checkbox"/>
				Both	<input type="checkbox"/>
Tue			<p><b><u>Please give further details here</u></b> (please read guidance note 3)</p>		
Wed					
Thur					
Fri			<p><b><u>State any seasonal variations for entertainment of a similar description to that falling within (e), (f) or (g)</u></b> (please read guidance note 4)</p>		
Sat			<p><b><u>Non standard timings. Where you intend to use the premises for the entertainment of a similar description to that falling within (e), (f) or (g) at different times to those listed in the column on the left, please list</u></b> (please read guidance note 5)</p>		
Sun					

<b>Provision of facilities for making music</b> Standard days and timings (please read guidance note 6)			<b><u>Please give a description of the facilities for making music you will be providing</u></b>	
			<b><u>Will the facilities for making music be indoors or outdoors or both – please tick</u></b> (please read guidance note 2)	
Day	Start	Finish	Indoors	<input type="checkbox"/>
			Outdoors	<input type="checkbox"/>
			Both	<input type="checkbox"/>
Mon			<b><u>Please give further details here</u></b> (please read guidance note 3)	
Tue				
Wed				
Thur			<b><u>State any seasonal variations for the provision of facilities for making music</u></b> (please read guidance note 4)	
Fri			<b><u>Non standard timings. Where you intend to use the premises for provision of facilities for making music at different times to those listed in the column on the left, please list</u></b> (please read guidance note 5)	
Sat				
Sun				



J

<b>Provision of facilities for dancing</b> Standard days and timings (please read guidance note 6)			<b><u>Will the facilities for dancing be indoors or outdoors or both – please tick</u></b> (see guidance note 2)	Indoors	<input type="checkbox"/>
				Outdoors	<input type="checkbox"/>
				Both	<input type="checkbox"/>
			<b><u>Please give a description of the facilities for dancing you will be providing</u></b>		
Day	Start	Finish	<b><u>Please give further details here</u></b> (please read guidance note 3)		
Mon					
Tue					
Wed			<b><u>State any seasonal variations for providing dancing facilities</u></b> (please read guidance note 4)		
Thur					
Fri			<b><u>Non standard timings. Where you intend to use the premises for the provision of facilities for dancing entertainment at different times to those listed in the column on the left, please list</u></b> (please read guidance note 5)		
Sat					
Sun					

**K**

<b>Provision of facilities for entertainment of a similar description to that falling within i or j</b> Standard days and timings (please read guidance note 6)			<b><u>Please give a description of the type of entertainment facility you will be providing</u></b>		
<b>Day</b>	<b>Start</b>	<b>Finish</b>	<b><u>Will the entertainment facility be indoors or outdoors or both – please tick</u></b> (please read guidance note 2)	Indoors	<input type="checkbox"/>
Mon				Outdoors	<input type="checkbox"/>
				Both	<input type="checkbox"/>
Tue			<b><u>Please give further details here</u></b> (please read guidance note 3)		
Wed					
Thur			<b><u>State any seasonal variations for the provision of facilities for entertainment of a similar description to that falling within i or j</u></b> (please read guidance note 4)		
Fri					
Sat			<b><u>Non standard timings. Where you intend to use the premises for the provision of facilities for entertainment of a similar description to that falling within i or j at different times to those listed in the column on the left, please list</u></b> (please read guidance note 5)		
Sun					

L

Late night refreshment Standard days and timings (please read guidance note 6)			Will the provision of late night refreshment take place indoors or outdoors or both – please tick (please read guidance note 2)	Indoors	<input checked="" type="checkbox"/>
				Outdoors	<input type="checkbox"/>
				Both	<input type="checkbox"/>
Day	Start	Finish			
Mon	23.00	05.00	<b><u>Please give further details here</u></b> (please read guidance note 3) HOT DRINKS FOR CONSUMPTION ON THE PREMISES ONLY		
Tue	23.00	05.00			
Wed	23.00	05.00	<b><u>State any seasonal variations for the provision of late night refreshment</u></b> (please read guidance note 4)		
Thur	23.00	05.00			
Fri	23.00	05.00	<b><u>Non standard timings. Where you intend to use the premises for the provision of late night refreshment at different times, to those listed in the column on the left, please list</u></b> (please read guidance note 5)		
Sat	23.00	05.00			
Sun	23.00	05.00			

**M**

<b>Supply of alcohol</b> Standard days and timings (please read guidance note 6)			<b>Will the supply of alcohol be for consumption (Please tick box)</b> (please read guidance note 7)	On the premises	<input type="checkbox"/>
				Off the premises	<input type="checkbox"/>
				Both	<input type="checkbox"/>
Day	Start	Finish			
Mon			<b>State any seasonal variations for the supply of alcohol</b> (please read guidance note 4)		
Tue					
Wed					
Thur			<b>Non standard timings. Where you intend to use the premises for the supply of alcohol at different times to those listed in the column on the left, please list</b> (please read guidance note 5)		
Fri					
Sat					
Sun					

State the name and details of the individual whom you wish to specify on the licence as premises supervisor

Name	
Address	
Postcode	
Personal Licence number (if known)	
Issuing licensing authority (if known)	

**N**

**Please highlight any adult entertainment or services, activities, other entertainment or matters ancillary to the use of the premises that may give rise to concern in respect of children (please read guidance note 8)**  
 NONE

**O**

<b>Hours premises are open to the public</b> Standard days and timings (please read guidance note 6)			<b>State any seasonal variations</b> (please read guidance note 4)
Day	Start	Finish	
Mon	08.00	05.00	<p><b>Non standard timings. Where you intend the premises to be open to the public at different times from those listed in the column on the left, please list</b> (please read guidance note 5)</p>
Tue	08.00	05.00	
Wed	08.00	05.00	
Thur	08.00	05.00	
Fri	08.00	05.00	
Sat	08.00	05.00	
Sun	08.00	05.00	

**P** Describe the steps you intend to take to promote the four licensing objectives:

**a) General – all four licensing objectives (b,c,d,e) (please read guidance note 9)**

See below

**b) The prevention of crime and disorder**

A buzzer entry system will be used between 23.00 and 05.00.

**c) Public safety**

Fire safety equipment will be checked regularly and any requirements made by the Fire Safety Officer will be complied with.

**d) The prevention of public nuisance**

There will be no take away food or drink.

Signs will be displayed at the exit reminding customers to leave quietly and respect the neighbours.

**e) The protection of children from harm**

No-one under 18 will be permitted entry to the premises after 23.00.

Please tick yes

- I have made or enclosed payment of the fee
- I have enclosed the plan of the premises
- I have sent copies of this application and the plan to responsible authorities and others where applicable
- I have enclosed the consent form completed by the individual I wish to be premises supervisor, if applicable
- I understand that I must now advertise my application
- I understand that if I do not comply with the above requirements my application will be rejected

**IT IS AN OFFENCE, LIABLE ON CONVICTION TO A FINE UP TO LEVEL 5 ON THE STANDARD SCALE, UNDER SECTION 158 OF THE LICENSING ACT 2003 TO MAKE A FALSE STATEMENT IN OR IN CONNECTION WITH THIS APPLICATION**

**Part 4 – Signatures** (please read guidance note 10)

**Signature of applicant or applicant’s solicitor or other duly authorised agent** (See guidance note 11). **If signing on behalf of the applicant please state in what capacity.**

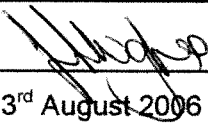
Signature	
Date	23 <sup>rd</sup> August 2006
Capacity	AUTHORISED AGENT

**For joint applications signature of 2<sup>nd</sup> applicant or 2<sup>nd</sup> applicant’s solicitor or other authorised agent.** (please read guidance note 12). **If signing on behalf of the applicant please state in what capacity.**

Signature	
Date	
Capacity	

**Contact name (where not previously given) and postal address for correspondence associated with this application** (please read guidance note 13)

J & H LICENSING CONSULTANTS  
35 WALFIELD AVENUE  
WHETSTONE

<b>Post town</b>	LONDON	<b>Post code</b>	N20 9PS
<b>Telephone number (if any)</b>	0208 446 8643		
<b>If you would prefer us to correspond with you by e-mail your e-mail address (optional)</b>			

# SALONICA CAFE

1 Grand Parade  
Green Lanes, Harringay,  
London N4 1JX

## GROUND FLOOR PREMISES

### LATE NIGHT REFRESHMENT LICENCE APPLICATION

Scale 1:100 Date: August 2006



FIRE BLANKET



FIRE EXTINGUISHER



PLAY MACHINE

Drawings by:

**A1 PLANS**  
**REGENTS AVENUE,**  
**PALMERS GREEN, N13 5UR**

DRAWING NO. 864/2.1GrandParadeN4.01/2

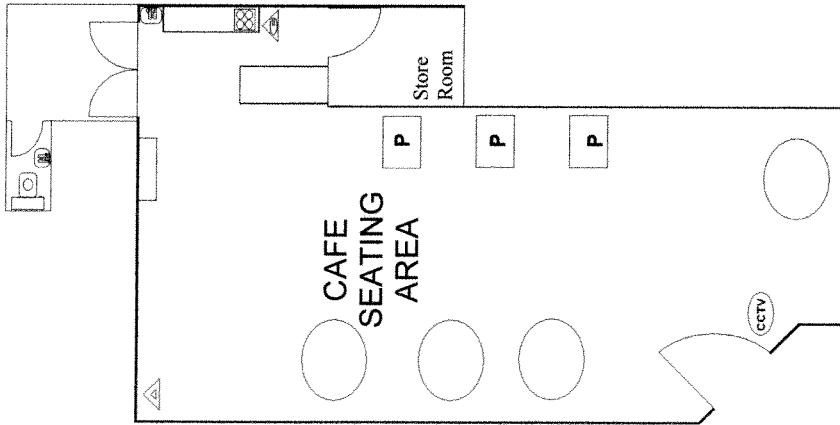



**APP 2**

## LICENSING CONSULTATION -INTERNAL MEMO

To: D Barrett, Licensing Officer

From: S Thompson, EHO Noise Team

Cc: D Pearce Noise Team Leader

Date: 21<sup>st</sup> September 2006

Premises: Salonica Café 1 Grand Parade Green Lanes N4

Type of application: LA 2003.

---

I would like to confirm that the above proposal has been discussed with regard to the prevention of public nuisance. On behalf of Enforcement Service Noise Team I would like to:

Make representations on the Application.

On the following grounds:

The proposed operating hours are inappropriate due to the close proximity of residential dwellings. The noise caused by patrons exiting the premises and utilising the external area, including the light-well is likely to be detrimental to the residential amenity.

### **Supporting Information**

The premise is located in an area that has mainly commercial premises on the ground floor with domestic residential accommodation above. The premises is situated on a busy high road. A review of the council's records relating to the premises has indicated that the service has been in receipt of the following nuisance complaints:

The only complaint about noise dates back to 1998 and no action was considered necessary on that occasion

Visits have been carried out between 23.35 and 0310. Although no noise nuisance has been witnessed, Salonica café was open for business.

### **Informative**

I would recommend the following conditions to the operating schedule:

**Operating hours**

That the premises close no later than 02:30hrs Sunday to Thursday and 03:30hrs Fridays and Saturdays

**Works Conditions**

**Prevention of nuisance from noise/vibration**

All doors to be fitted with acoustic seals- to minimise noise from the premises.

Rear access doors to be fitted with self-closing devices (in accordance with BS6458 Part 1 1984)

The licensable activity shall conclude 30 minutes before the premises is due to close to prevent excessive noise breakout as the premises empties

**Management conditions**

**Prevention of nuisance from noise/vibration**

All doors and windows will remain closed during the licensed activities. Where a door is used for patrons to enter or leave the premises the door will be fitted with a self-closing device and staff told to ensure that it is not propped open.

Where necessary, adequate and suitable mechanical ventilation should be provided to public areas.

**Management conditions**

**Outside Areas**

Signs shall be displayed instructing patrons to recognise the residential nature of the area and conduct their behaviour accordingly.

The management reserve the right to ask patrons to move inside the premises or leave if it is felt that they could be disturbing neighbours.

**Recommendation**

After considering the application and the unsatisfactory design of the rear yard; it is felt that the proximity and nature of noise sensitive domestic premises is likely to be detrimental to the residential amenity.

The Noise Team do not oppose the application but the licence, if granted, will require special conditions attached. See above

---

**From:** "GLANVILLE, Philip" <glanvillep@parliament.uk>  
**To:** "Di Janus" <di.janus@virgin.net>; "LCSP [Ladder Community Safety Partnership]" <lcsp@blueyonder.co.uk>  
**Sent:** 19 September 2006 10:49  
**Subject:** "Salonica Cafe, 1 Grand Parade, Green Lanes, Haringey N4"

To whom it may concern:

David Lammy MP echoes the feelings of local residents:

"I am concerned that, given the struggles that have already taken place to bring about the enforcement of existing licences, that cease at 2am, an extension to 5am is a distinctly retrograde step. It risks a return to the previous problems faced on Green Lanes, including increased levels of crime, anti-social behaviour and noise caused by very late hours, all of which we have together strived to reduce. I support the LCSP and nearby residents who want to keep the premises limited to a 2am closure, at the latest."

Sent on behalf of David Lammy MP

---

**Philip Glanville**

Assistant to David Lammy MP

T +44 (0) 20 7219 0767

glanvillep@Parliament.uk

[www.davidlammy.co.uk](http://www.davidlammy.co.uk)

---

This e-mail is confidential to the intended recipient. If you have received it in error, please notify the sender and delete it from your system. Any unauthorised use, disclosure, or copying is not permitted. This e-mail has been checked for viruses, but no liability is accepted for any damage caused by any virus transmitted by this e-mail.

---

No virus found in this incoming message.

Checked by AVG Free Edition.

Version: 7.1.405 / Virus Database: 268.12.5/450 - Release Date: 18/09/2006

19/09/2006

## LADDER COMMUNITY SAFETY PARTNERSHIP

*...keeping crime off*

Incorporating the Are You Sure? campaign.

P.O. Box 32109 London N4 1GN

Telephone: 07931 761 558

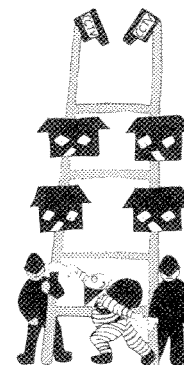

*the "Ladder"*

Daliah Barrett  
Environmental Control Service  
Civic Centre  
Wood Green  
London N22 8LE

10<sup>th</sup> September 2006

Dear Ms Barrett

**Late-night premises licence Salonica Café, 1 Grand Parade, Green Lanes, N4 1JX  
Applying for provision of late-night refreshment until 05.00 daily**

### 1 INTRODUCTION

The Ladder Community Safety Partnership (LCSP) contains representatives of Neighbourhood Watches and Residents' Associations from the 'Ladder' roads, adjacent to Green Lanes, Harringay, and from Wightman Road and Green Lanes itself. We are an independent group, although working in partnership with Haringey Council and the Metropolitan Police where appropriate.

**We are writing to you as members of the LCSP to oppose this application.**

**We believe that in the context of the well known problems in the area, coupled with high-density residential accommodation, granting a licence for the hours requested would be against the general principles of Haringey's Licencing Policy and specifically under the following headings:**

- The Prevention of Crime and Disorder
- Public Safety
- Prevention of Public Nuisance

**We are concerned that the applicant has only addressed these key issues in a very limited way in his application which could indicate a lack of understanding and/or commitment to their importance.**

More information on why we believe the Committee should reject this application is provided under appropriate headings below.

## 2 PLANNING CONSIDERATIONS: PREVENTION OF PUBLIC NUISANCE

At the time of writing, we are uncertain of the planning status for all the component parts of this premises. However, the Licensing Sub-Committee will no doubt give due weight to any relevant details provided by Planning and, if applicable, append an Informative to any permissions which may, or may not, be granted.

## 3 REASONS FOR OBJECTING

### (a) Relevant sections of the Borough's Licensing Policy/Objectives

We believe the following statements in the Borough's Licensing Policy support our objections:

- *'the Council considers that licensing law plays a key role in both preventing and controlling ... anti-social behaviour ... by regulating and applying conditions to affect the number, location and hours of premises'* [2.4]
- *'the council will have special regard to the local impact of licensing on related crime and disorder ... particularly when concerning location, impact, operation and management of all proposed licenses, applications, renewals and variations of conditions'* [7.14]
- *'licensed premises, especially those operating late at night and in the early hours of the morning, can cause a wide range of nuisances that can impact on the people living, working or sleeping in the vicinity of the licensed premises. **The Council is committed to protecting the residents** in the vicinity of these licensed premises.'* [13.1]
- *'in particular, late night activities cause much of this nuisance. Late night cafes ... can have a number of adverse effects on the residents in the vicinity of these premises. Nuisance such as noise, litter, anti-social behaviour, lights and odour all contribute to the loss of amenity to the general public'* [13.2]
- *'the potential for additional crime and disorder and/or public nuisance is increased with longer hours.'* [18.1]
- *'operating hours between 23.00 and 07.00 are considered to give greater potential for noise nuisance'* [18.3]

**(b) Licensing Hours**

We believe that granting a permanent licence for such very late hours as 05.00 seven days a week is an unreasonable proposition, given the location of the premises in the heart of one of the most densely populated residential areas in the borough. There are numerous flats adjacent to and above the premises in Green Lanes, while residents in Seymour Road and St Ann's Road (behind) are also extremely close. The proposed opening times would mean that the premises would be open for 21/24 hours every day.

The LCSP understands that each application must be decided on its own merits; however we would point out that there are currently no licenced premises in Harringay Green Lanes regularly open until 5am throughout the week. All previous applications for such late hours have been refused by Licensing Sub-Committees, on the grounds of prevention of crime and disorder and prevention of public nuisance. We firmly believe that the same arguments apply in this case, too.

Previous refusals of very late hours in Green Lanes are as follows:

- (1) Salisbury Public House refused 3am Lic.Sub Cttee C 04.10.05 (NB this is directly next door to the current applicant's premises)
- (2) 403 Green Lanes late night café refused 5am Lic.Sub Cttee E 18.04.05
- (3) 429 Green Lanes late night café refused 4am Lic.Sub Cttee A04.07.06
- (4) 657 Green Lanes late night entertainment licence venue. refused 3am weekdays, 4am weekends Special Lic.Sub Cttee 08.08.06

**(c) The Prevention of Crime and Disorder**

We have seen the very brief comment relating to the prevention of crime and disorder put forward by the applicant (ie 'a buzzer entry system will be used between 23.00 and 05.00'). Given the very late hours requested for opening residents would like to highlight the following questions, drawn from App.2 of the borough's Licensing Policy Guidances:

- will CCTV be used and monitored to help prevent crime and disorder?
- will door supervisors be used at/in the premises?
- what practices are/will be in place to deal with the possibility of patrons under the influence of illegal drugs, and the supply of illegal drugs? (A particular problem in the Green Lanes area, as noted in the recently published Crime and Drugs Audit [LBH/Met.Police])
- procedures to deal with violence and/or anti-social behaviour?
- methods to discourage the handling and distribution of stolen goods etc?
- methods to address prostitution at the premises? (a particular problem on Green Lanes: Met. Police Taskforce 4 reported to the Green Lanes Strategy Group on 8 Sept 2005 that this was currently a serious concern with 5 prostitutes cautioned during the previous week)

**(d) Public Safety**

The applicant mentions checking fire safety equipment and Fire Safety officer regulations. We assume that all staff would be trained to ensure that all safety measures are known and implemented, especially for emergency situations such as evacuation. We also assume that the premises is compliant with all relevant building control rules and regulations.

**(e) Prevention of Public Nuisance**

The only comments from the applicant refer to *'no take-away food or drink'* and *'signs displayed at the exit reminding customers to leave quietly and respect the neighbours.'* There are therefore a large number of questions remaining unanswered, in particular:

- the steps taken, or proposed, by the applicant to prevent noise or vibration escaping from the premises (whether music, ventilation equipment or human voices)? The Licensing Policy states that this is *'particularly important in residential areas'*.
- the actions necessary to prevent disturbance from deliveries or collections at early or late hours, or staff cleaning up after closing time?
- the steps taken, or proposed, to prevent littering and fouling of public and open spaces - what specific measures are proposed by the business?
- the arrangement for storage and disposal of trade waste - would the very long hours sought by the applicant lead to increased waste storage and disposal problems?
- the arrangements for cleansing and keeping clean the vicinity of the premises - this will include litter, refuse and other items originating from the premises and fouling caused by customers.
- the steps taken, or proposed, by the applicant to prevent disturbances by customers arriving at or leaving the premises?
- what proposals have been made, or are proposed, for parking by customers and what effect will this have on local residents?
- in the event of customers using taxis or mini-cabs, what measures have been taken by the applicants to prevent disturbance to local residents?

**The Borough's Licensing Policy points out the special importance of the above issues after 23.00 and in residential areas. (See Appendix 2(3) and 13.2).**

**4. CONCLUSION**

We believe that the above points should be given due weight by the Licensing Sub-committee and that appropriate conditions should be specified in any licence granted.

We firmly believe that the proposed extremely late hours are totally unacceptable in the heart of our residential community. We further believe that the potential for noise nuisance and anti-social behaviour and crime are far too great for this application to be approved.



Yours sincerely

A handwritten signature in black ink, appearing to be 'JH' with a flourish at the end.

on behalf of the LCSP

[Approved by the representatives of Neighbourhood Watches and Residents' Associations in the following Roads:]

Representation from Green Lanes and the following Roads:

Umfreville Road	Wollaston Road
Burgoyne Road	Cavendish Road
Pemberton Road	Warham Road
Seymour Road	Hewitt Road
Allison Road	Beresford Road
Effingham Road	Fairfax Road
Falkland Road	Lausanne Road
Hampden Road	Sydney Road

For the attention of Dale Barrett / London Borough of Haringey Licensing

The Cafe at 1 Grand Parade has a license application to stay open 11pm – 5am each night.

The cafe already has been staying open 24 hours.

Because the cafe opens to a rear light well and passageway to toilets, there is often noise from people talking in the light well, making mobile phone calls, etc. right beneath the bedroom windows of all the flats above. Sometimes arguments have happened under our bedroom windows in the middle of the night, disturbing our sleep, and we have had to shout for them to stop.

We have been hoping that the council was going to stop the nighttime use of the cafe, so there would be less nighttime disturbance.

Yours sincerely

*Jacqueline Shannon*  
*J. Hudson*



2c Grand Parade  
Green Lanes  
London N5 1JX

2b Grand Parade, Green Lanes, Harringay, N4 1JX

12<sup>th</sup> September 2006

Re: Café / Social Club at 1 Grand Parade, Green Lanes, N4 1JX / application for 11pm-5am license.

We wish to make a representation about this license application.

We live at 2 Grand Parade (above shops, adjacent to the Salisbury pub) and have done so for many years. We have been increasingly suffering from nighttime noise & disturbance from the adjacent ground floor shop being used as a cafe/social club throughout the night.

Despite a planning refusal for change of use to a social club many years ago, the premises have been used as a daytime cafe/social club since then, with little disturbance. But nighttime use is causing much disturbance to the residential neighbours - mainly through the use of an outside toilet at the rear, and the noise from the open rear door below bedroom windows. The gambling can give rise to loud arguments (or high spirits) which, while not constant, occurs at anytime between 11pm and 7am, disrupting our sleep.

The ground floor shops have access onto the lightwell and yard at the rear, containing an outside toilet. There are 6 flats affected by this nighttime noise (12 bedrooms) at 1 & 2 Grand Parade.

As said before, the daytime use of the shop has not presented any problems, only the nighttime use. Other residents have been worried about confrontation with the nighttime users, with small groups of men stood outside, or sometimes in our doorway.

Reports of disturbances / loud arguments & fighting have been made to noise control and occasionally the police in the past. With the noise often being sudden and, in the case of a loud argument underneath bedroom windows, possibly only lasting some minutes, there is a disincentive to get up and call Noise Control, when there will be nothing for them to investigate when they get there; everyone has had their nights sleep disturbed though.

When planning permission was previously sought for change of use to a social club, it was refused because 'The proposed development would have adverse effects on the surrounding residential neighbours by reason of noise nuisance and general disturbance.' (HGY/1998/1513).

We attended Councillor Canver's surgery to see what could be done about this. She asked Robin Payne & Rob Curtis to respond; they have said the premises are being monitored by Haringey Environmental Crime Group officers.

Nighttime noise at the rear of the flats makes for an increasingly difficult home environment, with loss of sleep, having to keep windows closed to cut down noise, and a general sense of nighttime disturbance.

Yours sincerely

A handwritten signature in black ink, appearing to read 'D. Kramer', with a long, sweeping horizontal stroke extending to the right.

Duncan Kramer

c.c. Councillor Canver, Robin Payne, Rob Curtis.